

6D
A500 SECTION DETAIL AT DOOR HEADER
3" = 1'-0"

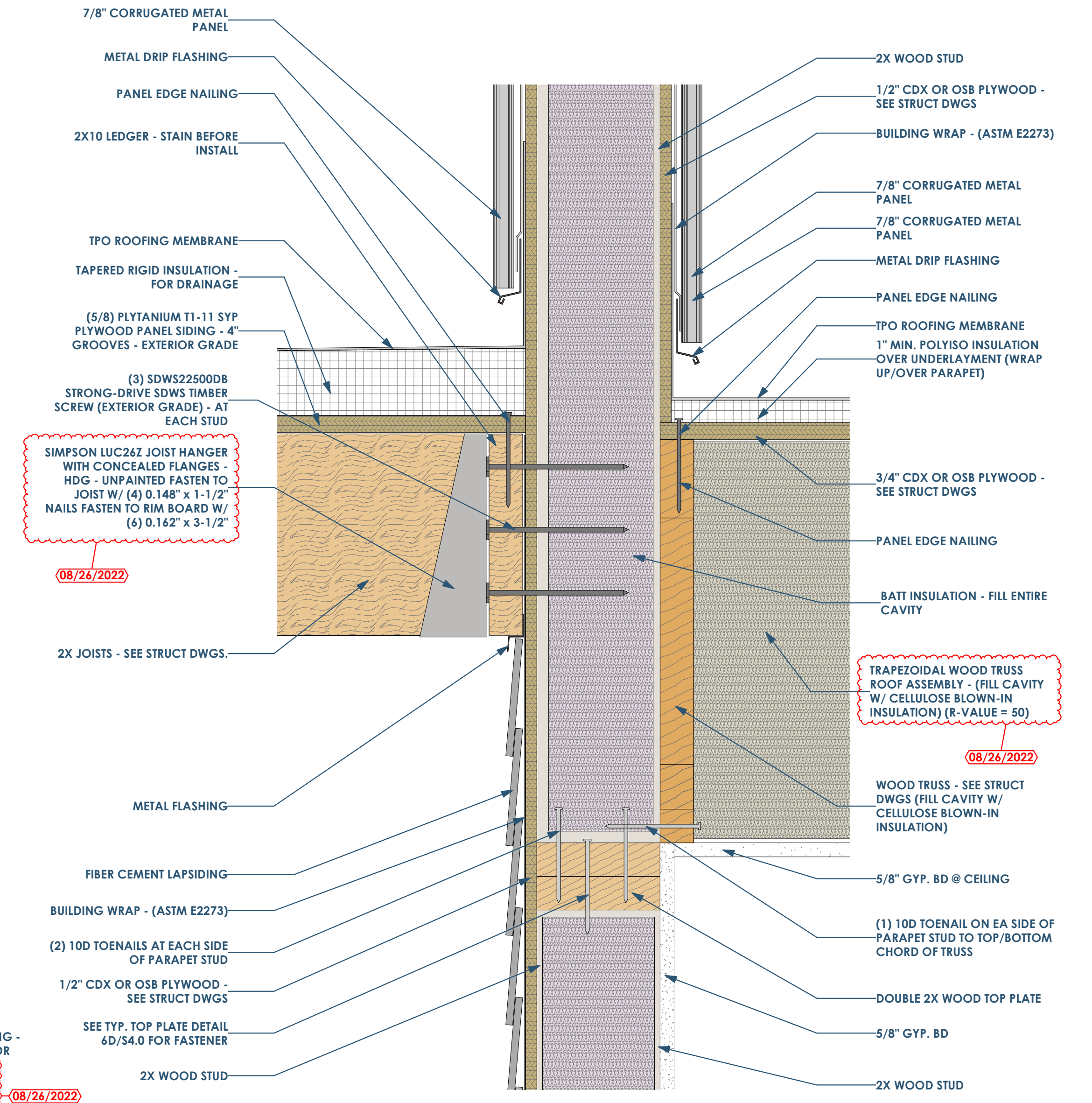

4C
A500 SECTION DETAIL AT PORCH ROOF AND PARAPET
3" = 1'-0"

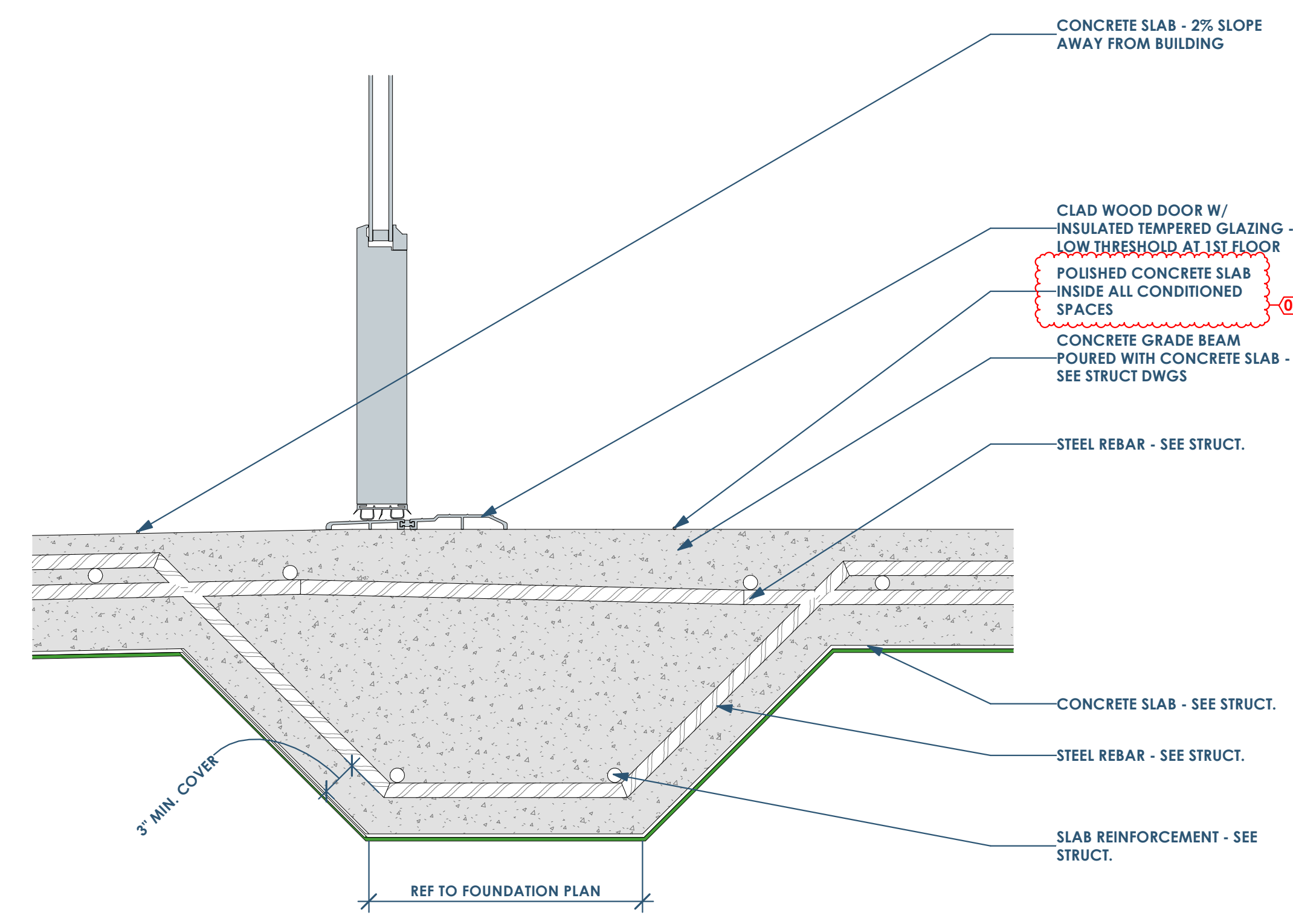

6B
A500 SECTION DETAIL AT DOOR SILL - 1ST FLOOR
3" = 1'-0"

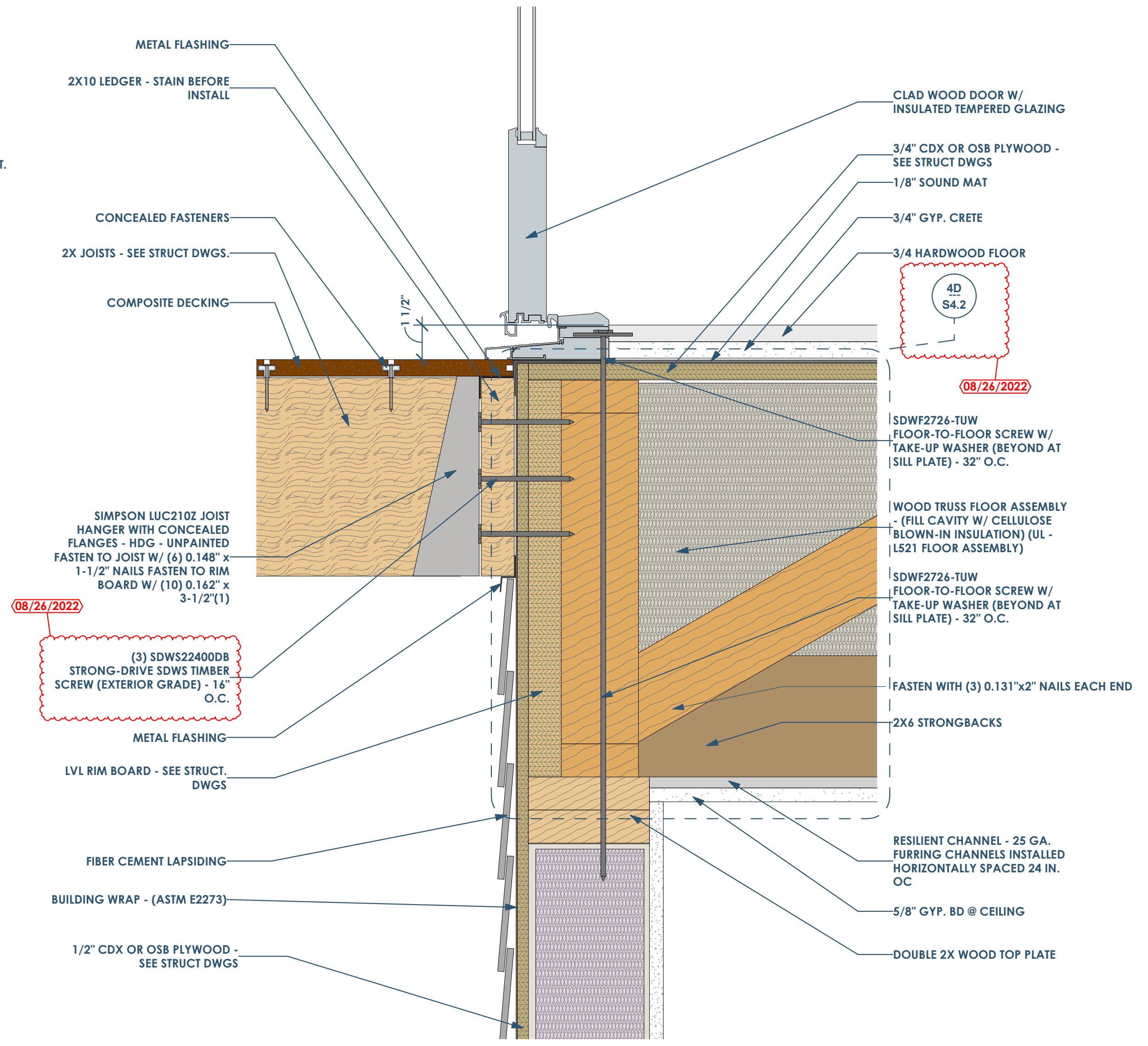

4A
A500 SECTION DETAIL AT UNIT DOOR SILL (2ND OR 3RD FLOOR)
3" = 1'-0"

RENOVATION Wranglers
 Owner: Renovation Wranglers
 102 E 26th St
 Bryan, TX 77803
 Katerneason@rw.com | 979.450.9969

ARCHITECTURE
 Architect of Record: LKB Architecture
 2929 Allen Pkwy Suite 200
 Houston, TX 77019
 isa@lkbarchitecture.com | 713.425.3076

STRUCTURAL
 Structural: Dudley
 Firm# 18677
 4102 Imperial Loop Drive
 College Station, TX 77845
 oorieka@dudleyeng.com | (979) 777-0720

MEP: AMC Engineers
 Texas Firm #9441
 508 E Jackson St # 552
 Burnet, TX 78611
 info@amcengineers.com | 512.535.6427

REGISTERED ARCHITECT
 LISA B. BIXLER
 STATE OF TEXAS
 22039
 8.26.22

This project, like most OpeningDesign's projects, is open source. (Attribution-ShareAlike 4.0 International-CC BY-SA 4.0) -freely available to any party for future use, assuming the terms such as Attribution and ShareAlike are honored.

Date	Description
04/10/2022	Issued for Permit
08/26/2022	Permit Revisions

openingdesign
 Architect: OpeningDesign
 17 S Fairchild | FL 7
 Madison, WI 53703
 ryan@openingdesign.com | 773.425.6456