

**RENOVATION Wranglers**  
 Owner: Renovation Wranglers  
 102 E 26th St  
 Bryan, TX 77803  
 Kateracaron@me.com | 979.450.9969

**LKB ARCHITECTURE**  
 Architect of Record: LKB Architecture  
 2929 Allen Pkwy Suite 200  
 Houston, TX 77019  
 lisa@lkbarchitecture.com | 713.425.3076

**DUDDLEY**  
 Structural: Dudley  
 Firm # 18677  
 6102 Imperial Loop Drive  
 College Station, TX 77845  
 corieko@dudleyeng.com | (979) 777-0720

**amc ENGINEERS**  
 MEP: AMC Engineers  
 Texas Firm #9441  
 508 E Jackson St # 552  
 Burnet, TX 78611  
 info@amcengineers.com | 512.535.6427

**REGISTERED ARCHITECT**  
 LISA B. BIXLER  
 22039  
 STATE OF TEXAS

*Lisa Bixler*  
 8.26.22

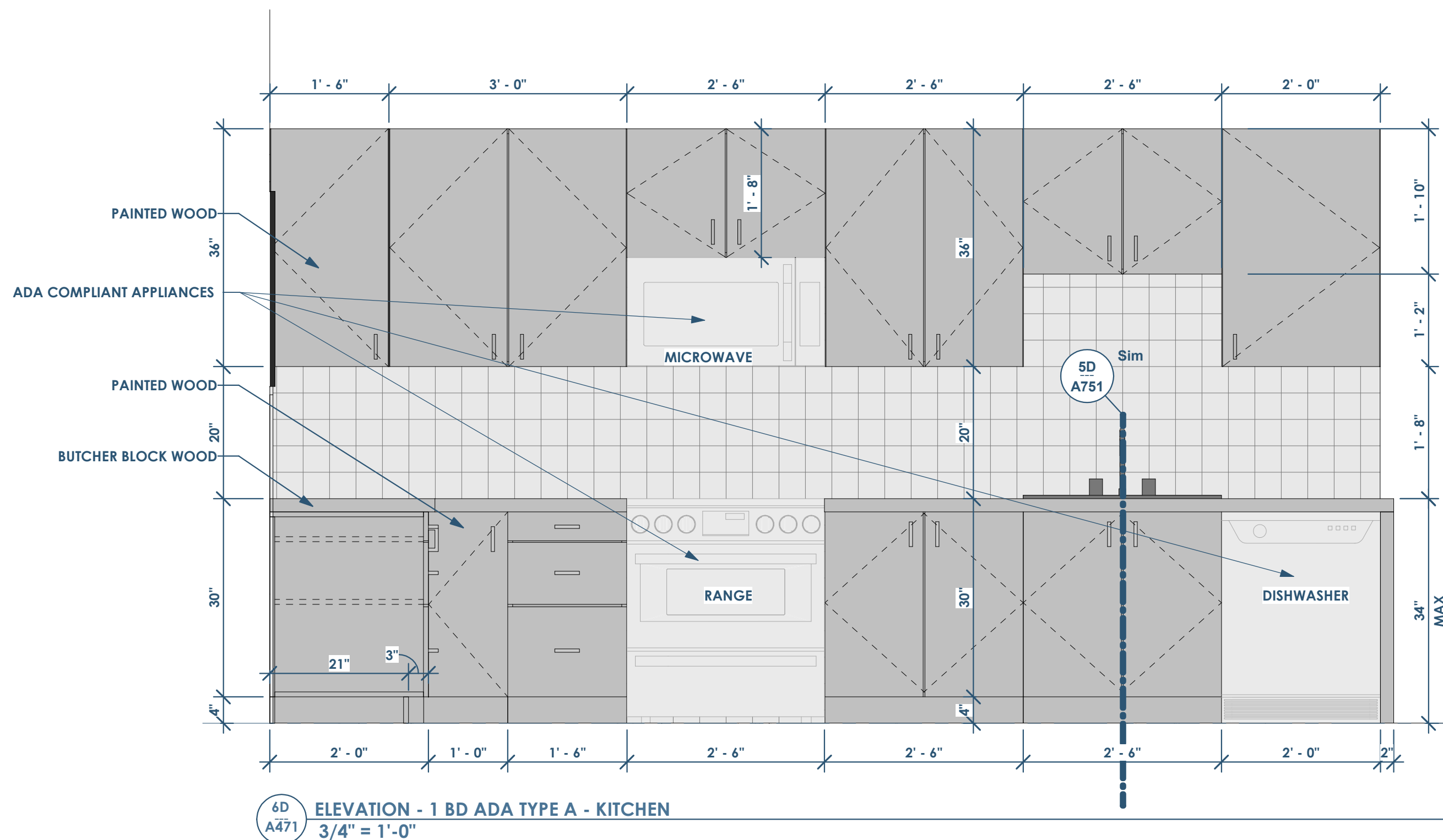

6D A471 ELEVATION - 1 BD ADA TYPE A - KITCHEN  
3/4" = 1'-0"

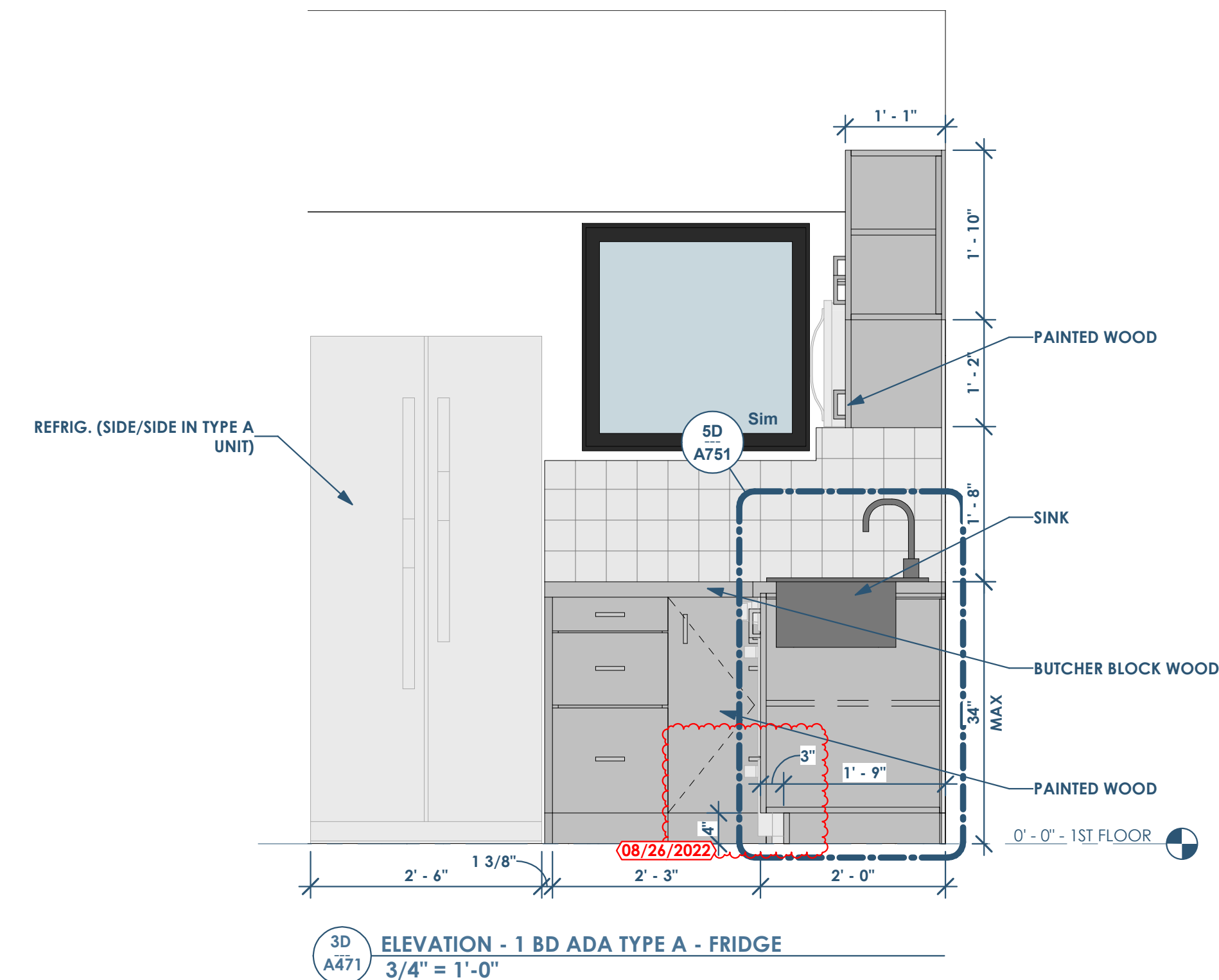

3D A471 ELEVATION - 1 BD ADA TYPE A - FRIDGE  
3/4" = 1'-0"

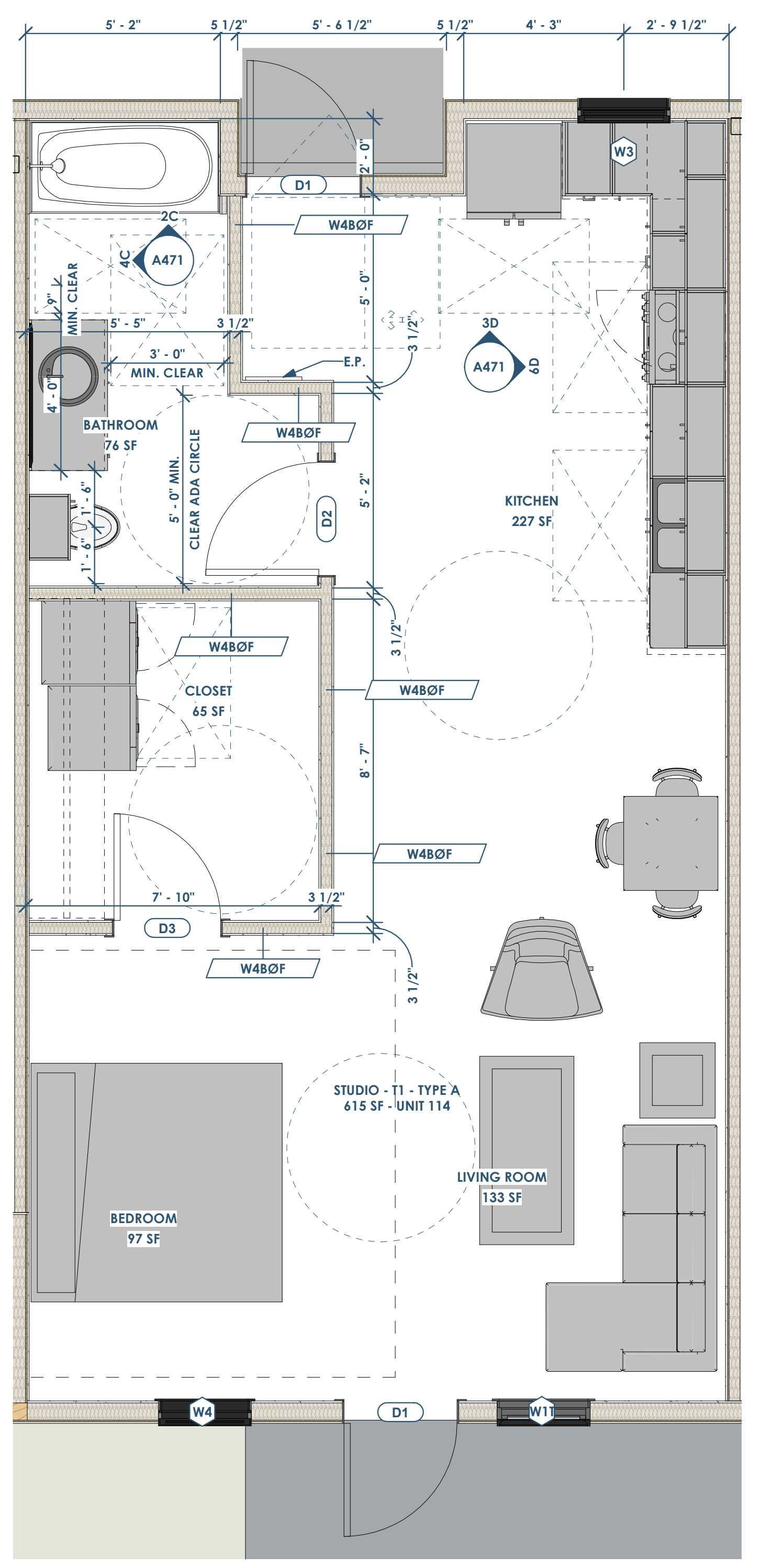

6A A471 UNIT PLAN - 1BD - ADA TYPE A  
3/8" = 1'-0"

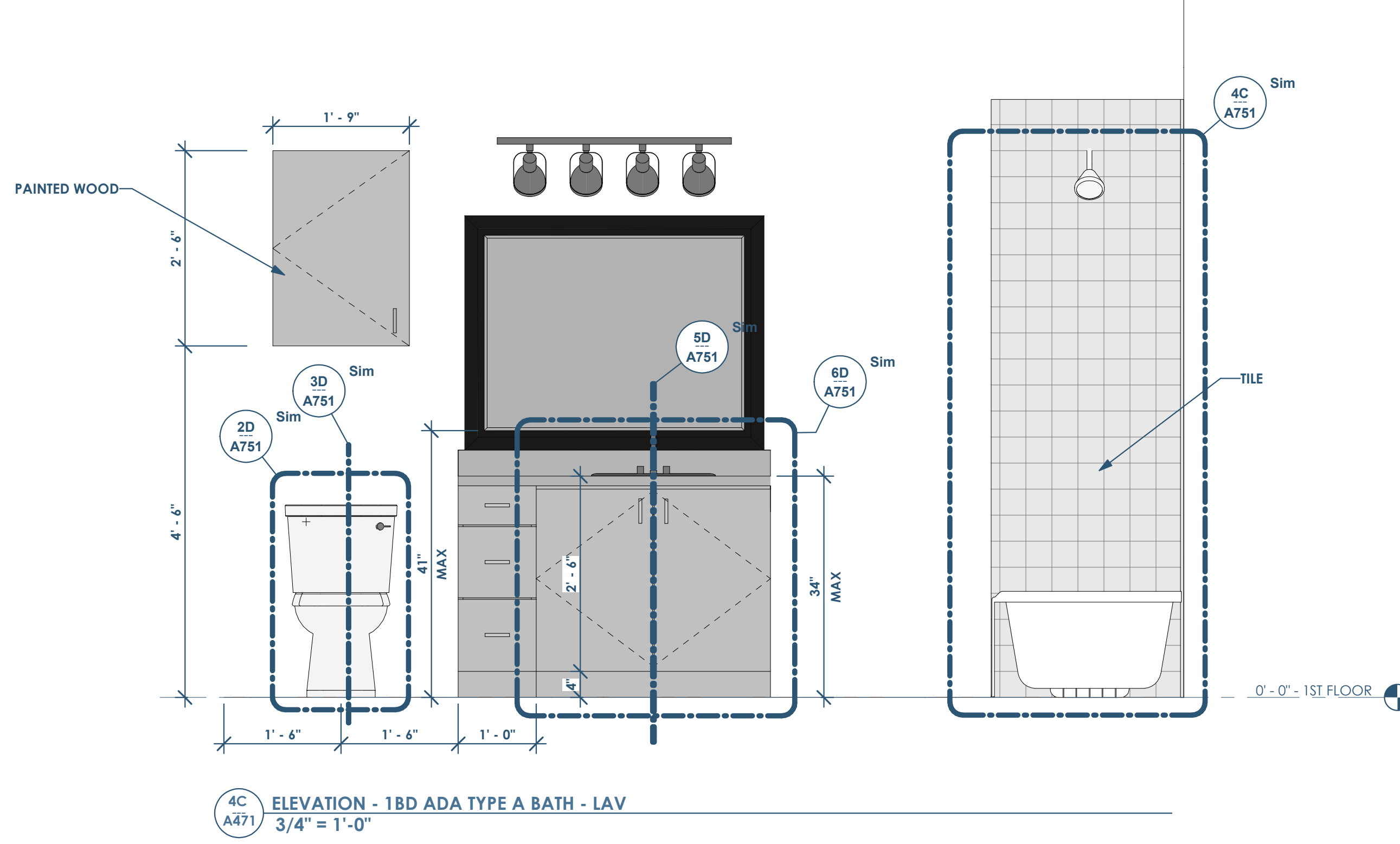

4C A471 ELEVATION - 1BD ADA TYPE A BATH - LAV  
3/4" = 1'-0"

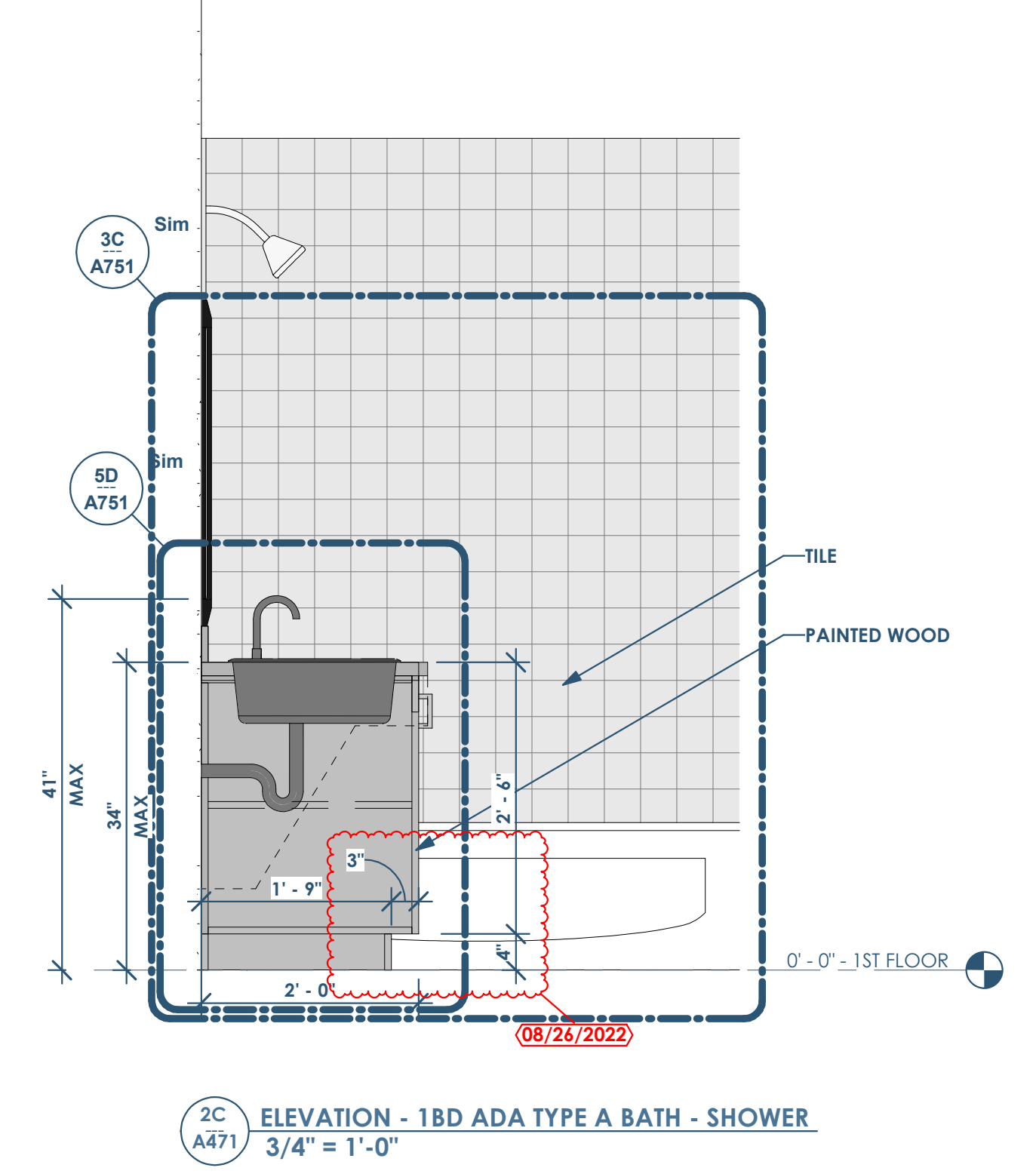

2C A471 ELEVATION - 1BD ADA TYPE A BATH - SHOWER  
3/4" = 1'-0"

- FLOOR PLAN NOTES**
- SEE A800 FOR PARTITION TYPES
  - SEE A600 FOR DOOR AND WINDOW TYPES
  - REFERENCE A751 FOR ACCESSIBILITY COMPLIANCE REQUIREMENTS
  - ALL FINISHES TO BE PROVIDED BY OWNER
  - MILLWORK AND APPLIANCES TO BE PROVIDED BY OWNER

This project, like most OpeningDesign's projects, is open source (Attribution-ShareAlike 4.0 International-CC BY-SA 4.0)-freely available to any party for future use, assuming the terms such as Attribution and ShareAlike are honored.

Date	Description
04/10/2022	Issued for Permit
08/26/2022	Permit Revisions